

## OMF 2000

FibreDrain® oil mist collector for continuous operation.



Nederman OMF oil mist eliminators are designed to handle large amounts of emulsion mist during continuous operation. They are developed with focus on high efficient filtration together with low maintenance cost.

Nederman OMF 2000 has as standard 3 filter-stages where the first 2 stages consists of filter cassettes with Nederman's FibreDrain® technology. Nederman have a wide range of different types of filters to suit many different kind of applications. The third stage consists of a HEPA filter in filter class H13 with an efficiency of 99,95% for MPPS according to EN1822. All tower built Nederman OMF units are prepared for use of pre filter. OMF 2000 have an built-in radial fan.

- Three filter stages, optional pre-filter
- Gauges for reading of pressure drop over each filter stage
- Extension legs
- Two inlet  $\varnothing$  200 mm with clamp ring connection
- Starter and motor protection included

Product name	OMF 2000
Standard	2009/125/EC
Volume (for shipping) (m <sup>3</sup> )	2.45
Noise level (dB(A))	50 Hz: 66 dB(A) @1,5 m from service side 60 Hz: 68 dB(A) @1,5 m from service side
Protection class	IP55
Filter efficiency (%)	99,95
Installation	[Indoor]
Material	Sheet metal, painted both in- and outside.
Working pressure (kPa)	Max 2500 Pa
Capacity (max airflow m <sup>3</sup> /h)	2000
Operating Temperature	40 deg C (inbuilt fan)
Power Voltage (V)	230/400
Frequency (Hz)	50
No of phases	3
Number of filter elements	3
Amperage (A)	7,6 / 4,4
Colour	NCS-S 1005 B20G
Weight (kg)	250
Power (kW)	2,2
Note	Plus 1 optinal filter element. Incl extension legs



## OMF 2000

Image	Description	Model
	OMF 2000, Inlet 2 x ø 200 mm clamp ring left or right. Drain 2 x 1" Female	12400008*

*\*Plus 1 optimal filter element. Incl extension legs*

## OMF 2000

	Accessory	Part No
	Drain pump box, 50 Hz	12400054*
	Drain container with piping	12400764**
	Optional FibreDrain Pre Filter ORF 610x610x96 mm.	12400039
	FibreDrain Filter 1 OMF; 600x600x292 mm	12400009
	FibreDrain Filter 2 OMF; 600x600x292 mm	12400010
	HEPA Filter H13; 610x610x292 mm	12400012
	Outlet transition, ø 200 mm, for OSF 1000 / OSF 1000-2 / OMF 1000-2 / OMF 2000	12400904
	Outlet transition, ø 250 mm for OSF1000 / OSF1000-2 / OMF1000-2 / OMF2000	12400905
	Outlet transition, ø 315 mm for OSF1000 / OSF1000-2 / OMF1000-2 / OMF2000	12400906
	Drain pump box, 50 Hz, 10 litre/min at 10m, including controller	12401330
	Frequency inverter with 2kPa pressure sensor. 2,2kW	73008914

\*Drain connection must be elevated min 200 mm from pump box support level

\*\*Drain connection must be elevated min 420mm from container support level

## OMF 2000

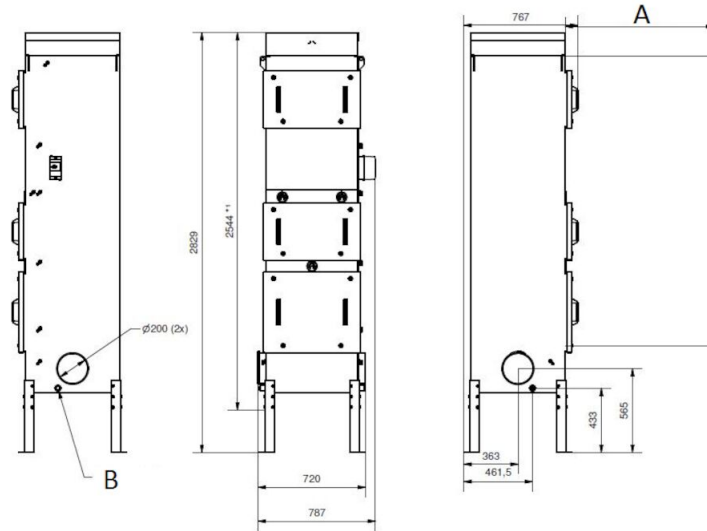

A) 1000 min filler service space

B) Drain stud (x2)