

OSF 2000

FibreDrain® oil smoke collector for continuous operation.



Nederman OSF oil smoke collectors are designed to handle large amounts of neat oil mist during continuous operation. They are developed with focus on high efficient filtration together with low maintenance cost.

Nederman OSF 2000 has as standard 3 filter-stages where the first 2 stages consists of filter cassettes with Nederman's FibreDrain® technology. Nederman have a wide range of different types of filters to suit many different kind of applications. The third stage consists of a HEPA filter in filter class H13 with an efficiency of 99,95% for MPPS according to EN1822. All tower built Nederman OSF units are prepared for use of pre filter. OSF 2000 have a top mounted radial fan.

- Three filter stages, optional pre-filter
- Gauges for reading of pressure drop over each filter stage
- Extension legs
- Two inlet \varnothing 315 mm with clamp ring connection

| | |
|-----------------------------|---|
| Product name | OSF 2000 |
| Standard | 2009/125/EC |
| Volume (for shipping) (m³) | 4.37 |
| Noise level (dB(A)) | 50/ 60 Hz: 70 dB(A) @1,5 m from service side with silencer |
| Protection class | IP55 |
| Filter efficiency (%) | 99,95 |
| Installation | [Indoor] |
| Material | Sheet metal, painted both in- and outside. |
| Filter cleaning method | [Draining] |
| Working pressure (kPa) | Max 3000 Pa |
| Capacity (max airflow m3/h) | 2000 |
| Operating Temperature | 60 deg C (limited by filter) |
| Power Voltage (V) | 400/690 |
| Frequency (Hz) | 50 |
| No of phases | 3 |
| Number of filter elements | 6 |
| Amperage (A) | 7,2 / 4,2 |
| Colour | NCS-S 1005 B20G |
| Weight (kg) | 345 |
| Power (kW) | 4 |
| Note | Plus 2 optional filter elements. Incl extension legs. |



OSF 2000

| [image] | Description | [model] |
|---|--|-----------|
|  | OSF 2000, Inlet 2 x ø 315 mm clamp ring left or right. Drain 2 x 1" Female | 12400011* |

**Plus 2 optional filter elements. Incl extension legs.*

OSF 2000

| | [accessory] | [partno] |
|---|--|------------|
|  | Drain pump box, 50 Hz, 10 litre/min at 5m, including controller | 12400054* |
|  | Drain container with piping | 12400764** |
|  | Frequency Inverter 4 kW incl transmitter 0 - 2 kPa | 12400990 |
|  | Silencer 90° Ø250 (OSF2000) | 12400014 |
|  | Transition NF 4 kW /Ø 250/1005 | 12400986 |
|  | Optional FibreDrain Pre Filter ORF 610x610x96 mm. | 12400039 |
|  | FibreDrain Filter 1 OSF; 600x600x292 mm | 12400006 |
|  | FibreDrain Filter 2 OSF; 600x600x292 mm | 12400007 |
|  | HEPA Filter H13; 610x610x292 mm | 12400012 |
|  | Drain pump box, 50 Hz, 10 litre/min at 10m, including controller | 12401330 |
|  | OMF/OSF/MQL mounting system for electrical components | 12401341 |

*Drain connection must be elevated min 200 mm from pump box support level

**Drain connection must be elevated min 420mm from container support level

OSF 2000

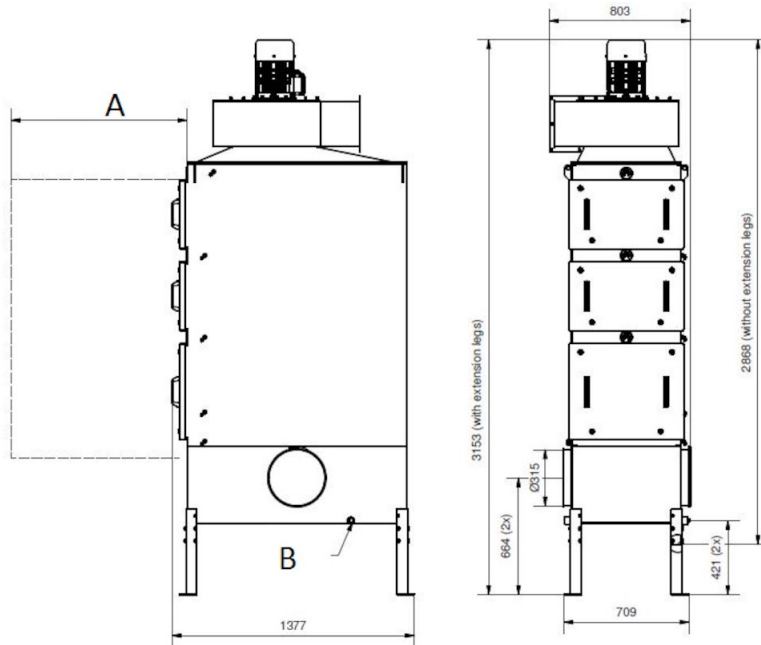

A) 1000 mm min filler service space

B) Drainage DN25 (2x)