

Back Pressure Flaps

Back pressure flaps for installation in LBR hopper

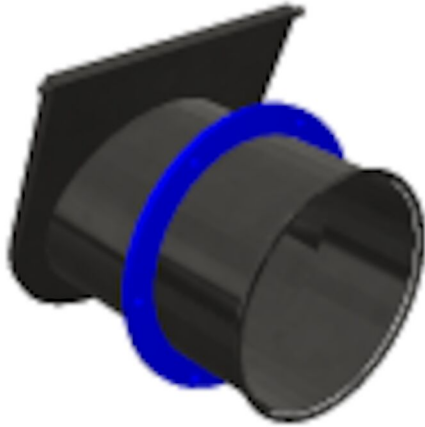

Welded construction in Nederman blue painted steel plate with strong rubber seal. Type QF is mounted with galvanised QF nipple complete with galvanised flange. Concerning dimensions of QF edges, flanges etc. we refer to the data sheets for QF duct systems and flange duct systems, respectively.

Back Pressure Flaps

Diameter (mm)	Connection	Model
200	QF	7943931
250	QF	7943932
315	QF	7943933
350	QF	7943934
400	QF	7943935
450	QF	7943936
500	QF	7943937
560	QF	7943938
630	QF	7943939
200	FL	7943940
250	FL	7943941
315	FL	7943942
350	FL	7943943
400	FL	7943944
450	FL	7943945
500	FL	7943946
560	FL	7943947
630	FL	7943948
710	FL	7943949
200	Spiro	5502898
250	Spiro	5502899
350	Spiro	5502901
400	Spiro	5502902
450	Spiro	5502903
500	Spiro	5502904
560	Spiro	5502905

Back Pressure Flaps

Back pressure flap in vertical wall

